



BUILDER	Feadship
LOA	48.20m / 158' 2"
BEAM	8.68m / 28' 6"
DRAFT	3.10m / 10' 2"
GT	499
YEAR	1997
REFIT	2022
ACCOM	10+2 guests in 5 cabins
CREW	10
SPEED	12.00 knots cruising
PRICE	€16,500,000 EUR US duty paid

GITANA

























































GITANA



GITANA







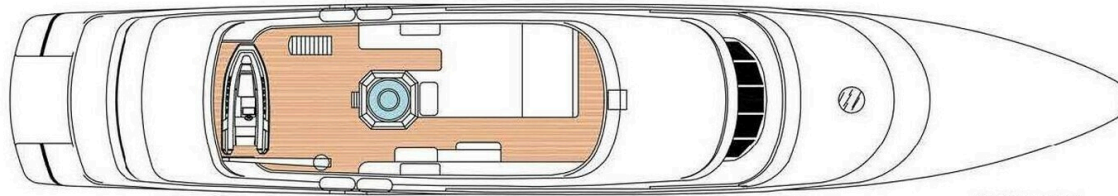

SUN DECK

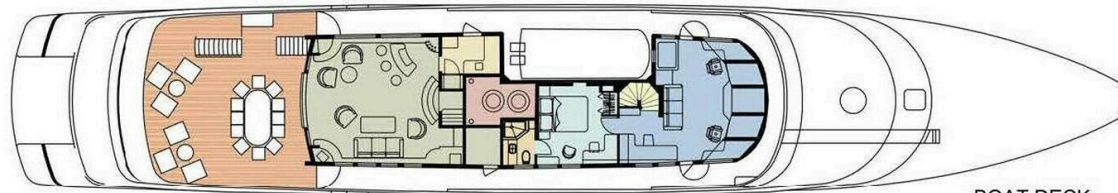

BOAT DECK



MAIN DECK

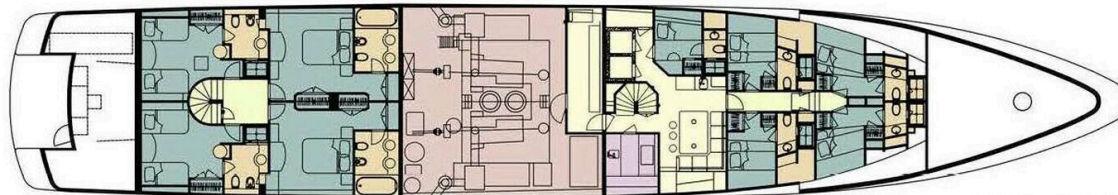

LOWER DECK



Gitana

CONTENTS

- 1 MAIN CHARACTERISTICS
- 2 DIMENSIONS
- 3 SPEED & RANGE UNDER POWER
- 4 CAPACITIES
- 5 ACCOMMODATION
- 6 MECHANICAL EQUIPMENT
- 7 NAVIGATION EQUIPMENT
- 8 COMMUNICATION EQUIPMENT
- 9 DECK EQUIPMENT
- 10 ENTERTAINMENT EQUIPMENT
- 11 GALLEY & LAUNDRY EQUIPMENT
- 12 SAFETY & SECURITY EQUIPMENT
- 13 TENDERS & WATERSPORTS EQUIPMENT
- 14 REFIT & MAINTENANCE NOTES
- 15 COMMENT



1. MAIN CHARACTERISTICS

TYPE	Displacement Motor Yacht
BUILDER	Feadship
HULL NO.	653
IMO NUMBER	1005435
MMSI NUMBER	319142000
NAVAL ARCHITECT	De Voogt Naval Architects
EXTERIOR DESIGN	Guido de Groot Design
INTERIOR DESIGN	John Munford Design
YEAR	1997
REFIT	2022
CLASSIFICATION	Lloyd's Register (+100 A1 MCA ISM LY3)
CONSTRUCTION	Steel Hull Aluminium Superstructure Teak Decks
CREW	Up to 10
FLAG	Cayman Islands
ENGINES	2 x 674 kW (904 Hp) Caterpillar 3508 DITA
GT	499
NT	149
DISPLACEMENT	Approx. 450 tons fully loaded

2. DIMENSIONS

LOA	48.20m / 158' 2"
LWL	41.75m / 137' 0"
BEAM	8.68m / 28' 6"
DRAFT	3.10m / 10' 2" max

3. SPEED & RANGE UNDER POWER

MAXIMUM SPEED	14.20 knots
CRUISING SPEED	12.00 knots
ECONOMICAL SPEED	10.00 knots
RANGE	3,500nm at 14.20 knots 4,300nm at 12.00 knots 5,900nm at 10.00 knots
FUEL CONSUMPTION	272 litres/hour (72 US gallons) at 14.20 knots 235 litres/hour (62 US gallons) at 12.00 knots 121 litres/hour (32 US gallons) at 10.00 knots

4. CAPACITIES

ACCOMMODATION	10 x Guests in 5 cabins 2 x Pullman beds
CREW	10 x Crew in 6 cabins
FUEL	70,787 litres / 18,700 US gallons
FRESH WATER	21,955 litres / 5,800 US gallons
HOLDING TANK	776 litres / 205 US gallons
LUBE OIL	2,100 litres / 555 US gallons
DIRTY OIL	2,100 litres / 555 US gallons
GREY WATER	3,950 litres / 1,043 US gallons
BLACK WATER	700 litres / 185 US gallons

5. ACCOMMODATION

AFT DECK

GITANA'S covered After Deck is comfortably furnished with L-shaped settees and cocktail tables port and starboard, along with additional casual seating. The stair to the large aft boarding and swim platform is aft on centerline to access the dive lazarette

and swim platform, where all watersports are launched.

MAIN SALON

Entry to the Main Salon is forward on centerline, via automatic sliding doors, opening to the full beam entertaining area aft, with oversize windows port and starboard for panoramic views of every port of call. The open arrangement, with couch, cocktail table and additional comfortable seating encourages relaxing interaction with the elegantly casual Deco - Caribbean motif and contrasting madrona burl and anigre, wood joinerwork.

DINING

The open Dining Salon adjoins forward, with an Oval dining table for twelve guests. Forward to starboard is the entry foyer which opens to the deck companionway, joins the main staircase to the skylounge and access to the galley and the Owner's office and stateroom forward.

GALLEY

The Galley is on the port side of the main deck forward of the dining area, with central island and large serving pantry adjoining the dining area which is perfect for seamless service. The galley features huge windows—a chef's dream. A dumb waiter services the pantry in the sky lounge above, further facilitating ease of service.

MASTER SUITE

GITANA features a full beam Master suite forward on the main deck with King bed, extensive closet storage, owner's desk, couch and chaise lounge, state of the art entertainment system and expansive windows port and starboard to further enhance the spaciousness of the stateroom. The ensuite Master Bathroom has a large steam shower, stunning Jacuzzi tub with skylight above, and breathtaking mural behind.

GUEST CABINS

Below deck are four guest staterooms with complimentary styling, clean lines and the elegant John Munford designed millwork seen throughout the yacht. There are

two queen staterooms with ensuite bathrooms with Jacuzzi tub and shower. Two additional twin staterooms (each with a Pullman bunk) have ensuite bathrooms with shower stalls complete with high finishes and luxurious marble work throughout. All staterooms have state of the art entertainment systems, individual A/C controls and safes for guest security.

BRIDGE DECK

Forward on the upper Bridge deck the Wheelhouse has recently upgraded equipment and soft furnishings. A unique and attractive feature of GITANA is the large 6 meter tender storage bay aft of the wheelhouse on the port side, which keeps all the owners deck areas free of unsightly tenders. There is a crew pantry on the port side as well, serviced by the dumbwaiter, to facilitate the five star crew service. Aft is the popular Sky Lounge, the main entertaining space for guests to enjoy the card table and long couches with plenty of seating options. The wide, oversized windows on this deck offer guests bird's eye views throughout their time onboard. A large screen TV and updated electronics including kaleidescape system provide guests with hours of entertainment.

The Bridge Deck Aft is the main al fresco dining location for GITANA, with a large oval table for seating up to 12 guests and comfortable aft seating arrangements. This area is completely covered keeping guests protected from sun and rain while eating or lounging. Additionally, there are wing doors on either side to protect this dining area from wind.

SUNDECK / FLYBRIDGE

The sundeck is the guest's favorite area to lounge, sunbathe, and arrive into ports in style. The sundeck boasts an enclosed gym area, which includes two treadmills, a weight bench and various weights, Jacuzzi and sunpads with ample seating for guests forward, and comfortable guest seating arrangements and a BBQ aft, perfect for the chef's delights. 2020, all sundeck soft goods, cushions etc., recovered.

CAPTAIN & CREW

Gitana can accommodate up to 10 crew in 6 cabins, including a Captain's cabin behind the wheelhouse and 5 additional crew cabins. Each crew cabin includes an ensuite bathroom. The crew mess is spacious and located aft of the crew cabins with adjacent laundry and walk in refrigerators and freezers. Below deck hides an extensive spare parts and dry storage area.

6. MECHANICAL EQUIPMENT

ENGINES	2 x 674 kW (904 Hp) Caterpillar 3508 DITA Diesel Both Engines had a major overhaul in January 2015 @ 18,700 hours Fully serviced by Pan Power during refit, all classification machinery requirements conducted (2022)
ENGINES HOURS	Port: 26,233 hours as of 19th Aug 2022 Starboard: 26,359 hours as of 19th Aug 2022
GENERATORS	2 x 156 kW (209 Hp) Caterpillar 3306 DITA Diesel (Overhauled Spring 2021, full OEM service by Feadship 2022)
GENERATORS HOURS	Port: 19,347 hours as of 19th Aug 2022 Starboard: 19,324 hours as of 19th Aug 2022
STABILISERS	Quantum ARC 3000 zero speed (8,500 hour rebuild 2022)
TOILET SYSTEM	Jets Vacuum heads, fresh water
SEWAGE SYSTEM	Hamann AG HL ContType II USCG and IMO approved (Full refit 2022)
WATER MAKER(S)	2 x Bluewater desalination: LX 3,400 gpd UV Sterilizer MP2SL Aquafine
STEERING SYSTEM	Tenfjord Hydraulic Gear type JR2130 (Full refit by

PROPELLER

GEARBOX

BOWTHRUSTER

AIR CONDITIONING

ELECTRICITY

SHORE POWER

BATTERIES

MAIN ENGINE START

GENERATOR START

HYDRAULICS

CONTROLS

COMPRESSORS

TUBES & PIPING

CHARGERS

BILGE WATER SYSTEM

ENGINE ROOM

Feadship 2022)

2 x 5-bladed skewed (reconditioned 2022)

2- Reintjes WAF 540. Ratio 3.955:1

Holland 75KW with Roer propeller (removed, rebuilt & reinstalled by Feadship 2022)

Heinen & Hopman chilled water cooling plant 400V/50HZ

Atlas 125kVA system

Engine Starting: 8 x Lifeline GPL8DA (4 x Per engine)

Generator Start: 6 x Deka Gel 12V (24v output)

Emergency: 6 x Deka Gel 12V

Electric 24V DC

Electric 24V DC

Stabilisers and Rudder systems

Marex electronic controls (2014)

2 x Hydrovane 502-10 semi-hermetic 380 volts with deck connections

Oil bath stern tubes for noise reduction (Akerboom Full system check, new seals, oil 2022)

Cunifr seawater piping throughout

8 x Mastervolt chargers

DVZ 250 VC Oilmaster OWS, OMD2005 (Feadship overhaul 2022)

ER fans with frequency controllers (soft starts)

3 x Refrigeration system / units, stainless steel

Main Engines & Engine Room deck plating repainted 2022

FUEL CENTRIFUGE

Alfa Laval Corporate AB MAB 103B (New 2022)

7. NAVIGATION EQUIPMENT

WING STATIONS

Wing stations completely rebuilt and rewired (2022)

MAGNETIC COMPASS

MK3 Observer

GYRO COMPASS

Anschutz Standard 20

SATELLITE COMPASS

Simrad GN70 with NEMA output & autopilot interface (2016)

AUTOMATIC PILOT

Anschutz

DEPTH SOUNDERS

Furuno 1100L/ B&G

DEPTH METERS

3 x B&G, bridge & wing stations (2022)

RADARS

2 x Furuno FR2010 Marine ARPA

AIS

Furuno F-150

DGPS/GPS RECEIVERS

2 x Furuno GP 170 (2017)

CHART PLOTTER

Transas and back up TimeZero

NAVTEX

Furuno GMDSS NX700 Receiver & Printer with 580kHz & 490kHz (2015)

LOG

JRC JLN203 Doppler

WIND INSTRUMENTS

Simrad IS 40 NEMA 2000 Wind Anemometer System (2015)

SEARCHLIGHTS

Carlisle & Finch Marine

CAMERA(S)

Panasonic Digital Video Multiplexer WJFS with 5 x security cameras

MISCELLANEA

Wempe Barometer & Ship's Clock
Jensen CD /Am / Fm Stereo

8. COMMUNICATION EQUIPMENT

SATCOM

Inmarsat Fleet 500 Sat Phone with voice, data, fax, GMDSS distress panel (2014)

ANTENNA

Inmarsat C with full GMDSS distress panel
SeaTel 4006 Hi-Speed Data Antenna upgraded with a Codan 8W BUC & Quadband LNB

DATA RECEIVER

Sierra Wireless MultiBand 4 LTE Cellular Data receiver with T-Mobile SIM

UHF

15 x ICOM F60

VHF

Furuno RT 2048 VHF DSC Radio

Sailor 6216 VHF DSC Radio (2015)

SSB

Furuno FS 1575 MF / HF Radio with distress panel (2015)

LOUDHAILER

Furuno LH3000 to Engine room / forward and aft

TELEPHONE EXCHANGE

2 x VOIP Voice lines

Panasonic digital super hybrid internal phone system

CELL SYSTEM

SureCall 2G/3G/4G direct connect with AT&T International SIM Card (2014)

SERVER

Dell Poweredge T-150 Server (Fall 2020) with domain & shore-side back up integration

HD

Buffalo TerraStation 8 TB onboard back up

WIFI

Pepwave WiFi Receiver (2014)

Wifi access throughout, subdivided into networks for guests, crew, A/V equipment, Kerio controlled Data from VSAT, 4G Cellular, Fleet 500, Pepwave Wifi Receiver

9. DECK EQUIPMENT

WINDLASSES	2 x Steen 23.50 Electric with chain stoppers
AFT WARPING CAPSTANS	2 x Steen 59 46 Electric
ANCHORS	2 x 360 KG Pool HHP type, flush mounted
ANCHOR CHAINS	1 x 6-shots (540') chain port 1 x 6-shots (540') starboard (2019)
BOAT CRANES & DAVITS	2 x Port side Bridge deck Gantry Davit: Van Driel SWL 2,750 lbs Sundeck Davit: Ackerboom 94267 SWL 1,250 lbs Foredeck Davit: Nautical Structures Euro 1,700 – SWL 1,700 lbs
PASSARELLE	5m Riviera ElectroHydraulic, phone and bell by Akerboom 94275
JACUZZI	On Sundeck (10-persons)
SWIM PLATFORM	With shower and deck cleats
COVERS	Various Tender and deck furniture

10. ENTERTAINMENT EQUIPMENT

GENERAL	Savant Media Control using Apple iPads, personal iPhone or iPad All zones can be linked and controlled for music via a "Party Mode" All zones may also be controlled via keypads found throughout the accommodation
MOVIE SYSTEM	Kaleidescape Movie Server system including 1,800 DVD / Blu-Ray disk storage vault Accessible to all spaces, gym, Master suite, media host for movie downloads onboard
SAT TV ANTENNA	KVH HD11 TVRO HD Satellite TV Antennas, cabling, associated below deck equipment

Includes arbitration via the KVH SmartSwitch,
laptop or iPad control interface from the ACUs (2016)

11. GALLEY & LAUNDRY EQUIPMENT

GALLEY

2 x Kupperbusch FEH 515 convection ovens (2014)
2 x Kupperbusch 4-plate cook tops (2014)
Hoshizaki icemaker
2 x Foster PC 2/3 ERT fridges
Samsung microwave oven
Miele PG 8056 dishwasher
Bravior coffee maker
3 x Deep stainless steel sinks
Dumbwaiter main deck to bridge
Foster Ice Cube Maker FIM20

PANTRY

Favorita espresso machine

LAUNDRY

2 x Fridges Isotherm
Trash compactor
3 x Miele Washing & Drying machines
(1 x new dryer & 1 x new washer 2022)
Miele Ironing system

12. SAFETY & SECURITY EQUIPMENT

SAFETY

4 x RDF 12Person life rafts
12 x Life rings

FIRE FIGHTING

2 x Smoke Buoys
 31 x Adult Solas approved life vests with strobes
 6 x Children's Solas approved life vests
 30 x Survival Suits
 2 x EPIRBs
 54 x Safety flares as required by class
 Full MCA LY3 Compliance Medical Kit from Medaire
 CO2 fire extinguishing in engine room and engineers control room
 Complete fire detection system
 Eltek ANX 95 fire guard fire alarms
 Cunifer fire piping in fire fighting system
 Fire hoses and nozzles as required by class
 Fireman axe
 2 x Fireman's suits, with breathing apparatus 52 x Extinguishers as required by class
 Fire fighting equipment in accordance with MCA code classification for commercially registered vessels International Code Flags
 CCTV System: Panasonic Digital Video Multiplexer WJFS
 4 x Security cameras watching permanently or sequential mode
 2 x Monitors in Bridge and Crew Mess
 Safes in Master, Captain and all Guest Cabins

SECURITY

13. TENDERS & WATERSPORTS EQUIPMENT

TENDERS

1 x 5.60m Williams Jet drive (available if buyer

desires)

1 x 4.30m Novurania 430 DL with Yamaha F60 (2013)

WATERSPORTS

2 x 2-person kayaks

Hobie 1-Person pedal kayak

2 x Paddleboards

Bauer Dive Compressor (2019)

DIVING

14. REFIT & MAINTENANCE NOTES

FEADSHIP REFIT 2021/22:

HULL & DECK

- 25-year Special Survey completed (May 2022) with no conditions of class
- Steel Hull fully audio gauged for Lloyds/MCA classification
- Bilge areas audio gauged in depth
- Full rebuild of steering system
- Rudders dropped, rudder shafts addressed, new bearings, new seals, stops renewed
- Sandblast entire underwater area back to bare steel, waterline area faired, 3 x coats of steel primer and 3 x coats under water antifouling
- Renewed all hull zincs
- Propspeed applied to propellers and bow thruster
- Comprehensive exterior paint refinishing by Feadship
- Full exterior hardware removal, steel and aluminium corrosion treated, re-faired, 3 x primer coats and 3 x coats of topcoat applied of premium Alexseal polyurethane with a gloss enhancer
- 50k in additional corrosion removal work topside
- 2 x New bridge deck windbreak doors with hardware renewed
- New Handrail bushings installed

- Teak decks serviced, margin boards refitted
- Underwater lights serviced
- Sea chests and exhaust descaled and needle gunned, primed/faired and antifouled
- Cathelco Anode system renewed
- Stbd and port main deck lockers steel floor replaced
- All grills removed sandblasted/primer/faired/top coated

MECHANICAL

- Full tail shaft surveys with new seals installed, new oil installed in system
- Propellers recondition, LR Bluing on shaft fit
- Thruster removed, fully rebuilt & reinstalled
- Complete major service to stabilisers and new hydraulic rams installed
- New Alfa Laval Centrifuge MB-103
- Heat exchangers removed and acid washed
- Lloyds Registry main engine and generator breakdown for inspection
- Complete OEM service to main engines and generators
- Main engine alignment verified
- Main engine injectors replaced or calibrated
- Updated/replaced all engine gauges
- Generator cylinder liners replaced
- Refit of air handler & extraction system
- Bilge and fire pumps replaced
- All hull valves replaced
- Replaced 3-way piping valves
- 2 x New water heaters and wiring system installed
- Generator exhaust heaters cleaned out
- Blackwater control box replaced
- All grey water, black water and drinking water tanks refurbished and coatings done

- Cleaned all dirty oil and blackwater tanks
- Corrosion in bilges addressed and recoated
- Engine room bilge pick up pipe replaced
- All fire pumps, bilge and grey water pumps rebuilt/replaced as necessary
- Hamman Black Water pumps fully rebuilt
- 22 x New overboard valve/thru hull fittings
- 12 x New thru hull/intake valves
- Replaced 4 x 3-way valves for bilge/fire pumps
- New Miele washer & dryer
- Anchor windlasses rebuilt
- Anchors shanks remanufactured
- New D-shackles on anchors
- Anchor de-rusted and protected
- New anchor controls and plugs
- Complete removal/rebuild nautical structures foredeck MOB davit
- Sundeck crane drive gear rebuilt
- Gantry cranes new controls and plugs
- New firefighting valves installed on all decks
- Air ducting stbd main deck air balancer replaced
- New control valves foredeck crane hydraulics
- Chiller seawater pumps seals replaced
- Chain locker discharge valve replaced
- Bosuns lockers taken back to bare steel/primed/top coated
- Main engine exhaust flange renewed
- Galley refrigeration new compressor/recharged
- New Lazzerette extractor fan
- New Jacuzzi controller

ELECTRICAL

- Complete re-wiring & waterproofing of wing stations

- 3 x New B&G depth displays, bridge and both wing stations
- Mains switch board Megger tested
- 3 x Main power breakers replaced
- Shore power extension made
- Main switchboard cleaned
- Breakers tested for overloads/replaced as needed
- New VSat Antenna controller and modem
- New transducer depth sounder
- Exterior lighting renewed
- Mast spreader lights replaced
- Mast dressing lights replaced
- NUC light system renewed
- Exterior light fixtures replaced as needed
- Exterior plugs replaced as needed
- Aft deck capstan connections renewed

GENERAL WORK

- All door and window caulking removed and renewed
- Exterior varnish stripped and renewed
- Teak on foredeck replaced between anchor windlasses
- Teak deck margin boards replaced in corroded areas
- Bridge interior glass coating removed
- Deck scupper grates replaced
- Bridge deck wing doors replaced with new hardware
- Re-chromed various pieces of hardware
- Tabletop veneers replaced

CLASS, FLAG STATE & SAFETY EQUIPMENT

- Full 25 Year Lloyds, Yacht (Maltese Cross) 100 A1 Yacht LMC all classification certificates issued with no conditions

- MCA LY-3 Re-Classification ready
- Cayman Islands Flag State Radio Survey completed and re-certificated
- Cayman Islands Annual Flag State inspection completed and re-certificated
- Cayman Islands interior fabrics fire treatment
- Anchor chain and fitting gauged for LR
- New Load Line Plimsoll marks installed
- Medical kits re-certified
- EPRIBS certified
- 2 x New SCBA firefighting equipment sets
- 3 x New RFD Life rafts, 1 x Re-certified
- All cranes and gantries load tested and certified
- MOB overboard crane hook replaced and certified
- Sidetracks load tested and recertified
- Compass deviation card new
- ECDIS renewals and charts updated

2021:

- Genset CAT 3306 Top End Overhaul in the Spring – 1,200 running hours since overhaul

2020:

- Air Knife and Thermal Bake cleaning of Generator DPF units – 2000 hrs since cleaning
- Replacement of 10 local Fan Coil Units of the A/C System
- Recover of Sun Deck Exterior soft goods
- New Carpet in Crew, Bridge, and Service Areas

2019:

- New Atlas 125 kVa Shorepower system
- Haul out, Bottom Job, Aft Seal rebuild by Akerboom
- New Anchor Chains – 6 shackles per side (540' each)

- New House, GMDSS, Main engine and Genset Start Battery Banks
- Bridge Deck, all Soft goods recovered
- New Dive Compressor – Bauer Model # IK120II-BH – 208 hrs on the unit

2016/17:

- 20 year Special Survey completed all in good order with no conditions of class
- Driveline was dismantled, surveyed, and reinstalled with new Centra Links and Vulkan Couplings
- Thickness measurement report shows hull in great condition
- Inframe overhauls on Generator 3306 A/E
- Repainted Main Engines and Engine Room Deck Plating
- New watermakers

2015:

- Inframe overhaul of Main engines
- Replaced engine and A/E exhaust lagging
- Replacement of majority of communication systems on bridge

2014:

- Full Paint from Mast to Water line using DuPont M600 at Rybovich plus bottom blast and recoat
- Retrofit of new Marex Controls
- Full A/V Upgrade to Savant/Kaleidescape
- Full interior refit including all furniture and soft goods
- New Teak Sundeck and reseamed other decks
- Refit of interior lighting system

15. COMMENT

GITANA's Feadship Pedigree has been nurtured since her original launch, with all systems consistently serviced upgraded with an unwavering eye to preventative

maintenance.

The design brilliance of John Munford coupled with the exterior styling flair of Guido de Groot and the unquestioned design, engineering and detailing expertise of the Feadship Devries yard, created this trend setting 499 GT Tri-deck Motor Yacht, which so elegantly bridges the gap between the most classic Feadships and the more modern, higher freeboard designs. In short, GITANA is simply stunning from all perspectives and she serves up four decks of luxurious comfort and entertainment, with a multitude of inviting outdoor living spaces for all to enjoy. Her Feadship Pedigree has been nurtured since her original launch, with all systems consistently serviced and upgraded with an eye to preventative maintenance.

GITANA has just completed a seven-month comprehensive structural, mechanical and cosmetic refit at Feadship's Scheepsbouw in their Makkum, Netherlands drydock facility. SHE is in turn-key condition, including a new paint job from mast top to waterline utilizing state of the art premium Alexseal polyurethane with a gloss enhancer added. Feadship also completely renovated the underwater surface area with a complete sand blasting back to bare steel then faired, undercoated and finished with coats of new antifouling paint. Additionally, she has had a comprehensive mechanical and running gear refurbishing; shafts/seals/rudders/bearings, full stabiliser system and bow thruster rebuilds.

GITANA has completed her Lloyds 25-year classification renewal with a flawless classification survey. The list of refit improvements to her essential systems is impressive, totaling over €3,400,000. She is ready in every respect to cruise all oceans of the world in complete comfort, safety and indeed, luxury.

KEY FEATURES

- Feadship pedigree
- Excellent ownership and maintenance history
- Only ever privately used

GITANA

- Full beam master on main deck
- 10+2 guests in 5 cabins
- Recently completed a multi-million Euro refit at Feadship including full repaint, engineering overhaul, 25-year Lloyds class survey

DISCLAIMER

This document is not contractual. All specifications are given in good faith and offered for informational purposes only. The publisher and company do not warrant or assume any legal liability or responsibility for the accuracy, completeness, or usefulness of any information and/or images displayed. Yacht inventory, specifications and charter prices are subject to change without prior notice. None of the text and/or images used in this brochure maybe reproduced without written consent from the publisher