

# MySky







Fans of award winning design will love this yacht as the interiors are a work of genuinely sophisticated contemporary art. Dutch studio Omega Architects has played with contrast in a spectacular way, combining black and white leather, black marble and backlit white onyx, glossy bookmatched makassar wood and focussing on circular forms in the social areas. The effect is incredibly impressive.

She's also a very successful charter yacht with an abundance of outside space, plenty of toys and a crew that consistently receive five star feedback. Up on the sun deck she has a climate controlled gym for workouts with a view. Once you have worked up a sweat why not freshen up with an outdoor shower followed by a walk aft for a dip in the jacuzzi and admire the views relaxing on the sunpads forward.

Down on the bridge deck aft you will find a beautiful shaded space for an al fresco lunch together with a luxurious sun lounge. At night a large TV folds down from above the table seamlessly transforming the space into an outdoor cinema for movies under the stars. Steps forward lead down to the Portuguese bridge, the perfect place for a sundowner, and there is a foredeck terrace ideal for sun lounging, exercise equipment or entertainment. Guests can enjoy snacks in the main deck aft lounge before heading down to the swim platform to play with all the watertoys.

MYSKY welcomes up to 12 guests in five spectacular cabins: a full beam main deck master with its own study and private balcony, plus two double cabins and two twin cabins on the lower deck, with an additional berth in each twin cabin.



# At a glance



Build

**2014, Heesen, The Netherlands**

---



Length

**51.1m (167.8ft)**



Guests

**12**



No. of guest cabins

**5**

---

## Key features

- **Aft deck cinema**
  - **Jacuzzi**
  - **Zero speed stabilisers**
-





**Main lounge**





**MySky bar**





Dining





Dining





**Exquisite cuisine**





Master





**Master en suite & study**





**Guest cabins**





**Sky lounge**





**Aft deck dining**





**Aft deck**





**Aft deck cinema**





**Sun deck**





Exterior







Toys





**Details**





MySky





MySky



# Deck plans

Sun deck

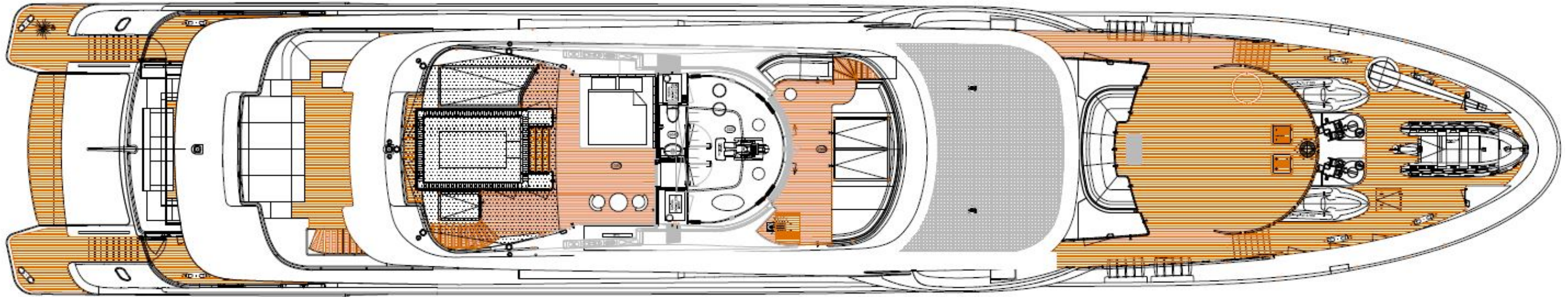

Wheelhouse deck

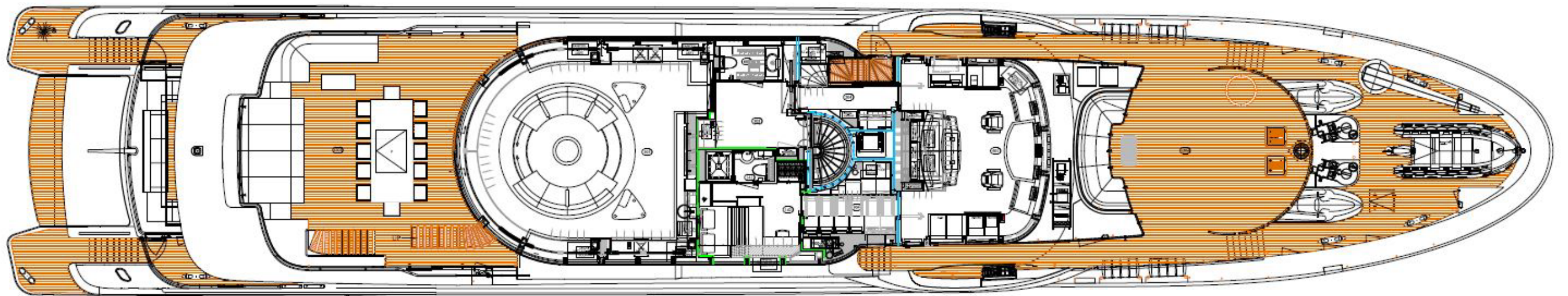



# Deck plans

Main deck

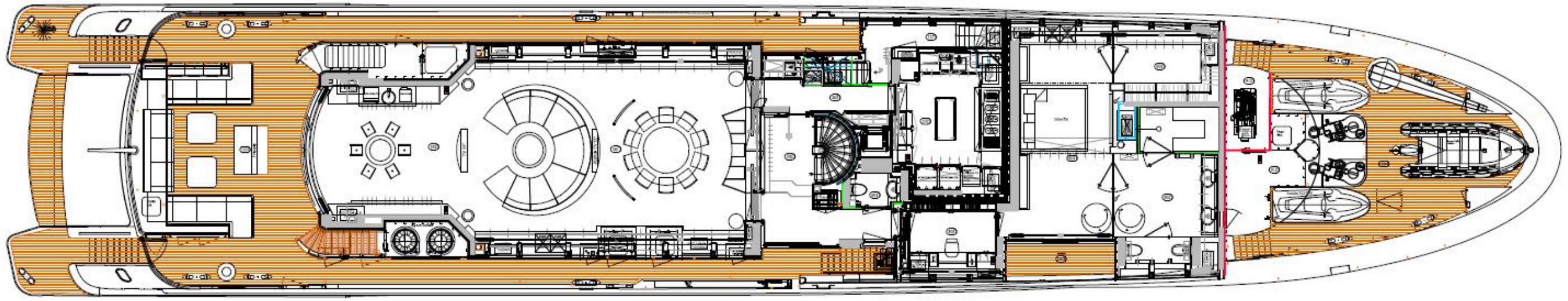

Lower deck

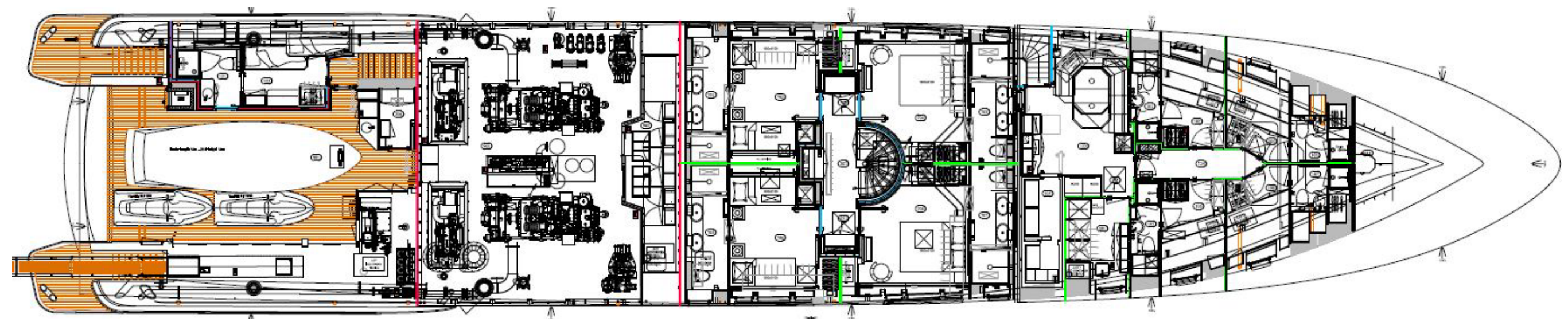



# Specification



Length  
**51.1m (167.8ft)**



Beam  
**9.6m (31.6ft)**



Draft  
**2.8m (9.2ft)**



Gross Tonnage  
**648**



Interior design  
**Eric van Egeraat**



Build  
**2014, Heesen**



Guests  
**12**



Cabins  
**5**



Cabin types  
**3 double, 2 twin**



Crew  
**11**



Maximum speed  
**15 knots**



Cruising speed  
**12 knots**



Fuel consumption (cruising)  
**360 Litres/Hr**



Engines  
**2 x MTU**



Watersports

**8m Meyer tender, 9.4m Goldfish tender, 2 x Seadoo jetskis, 2 x Seabobs, 2 x kayaks (1 double/ 1 single), inflatable toys and tows, waterskis, 2 x wakeboards, snorkelling gear, fishing gear**



Communication & Entertainment

**Kaleidescape, Apple TV and airplay, Jetstream for Russian TV, Icecrypt TV for other local freeview channels . VOIP, VSAT, FBB, Wifi internet access .**