



BUILDER	Ortona Navi
LOA	50.00m / 164' 1"
BEAM	9.19m / 30' 2"
DRAFT	2.71m / 8' 11"
GT	591
YEAR	2008
REFIT	2022
ACCOM	12 guests in 6 cabins
CREW	12
SPEED	12.00 knots cruising
PRICE	€14,995,000 EUR Price exc. VAT

ARBEMA



























MYKONOS
MUSE























































ARBEMA



ARBEMA



ARBONA











ARBEMA









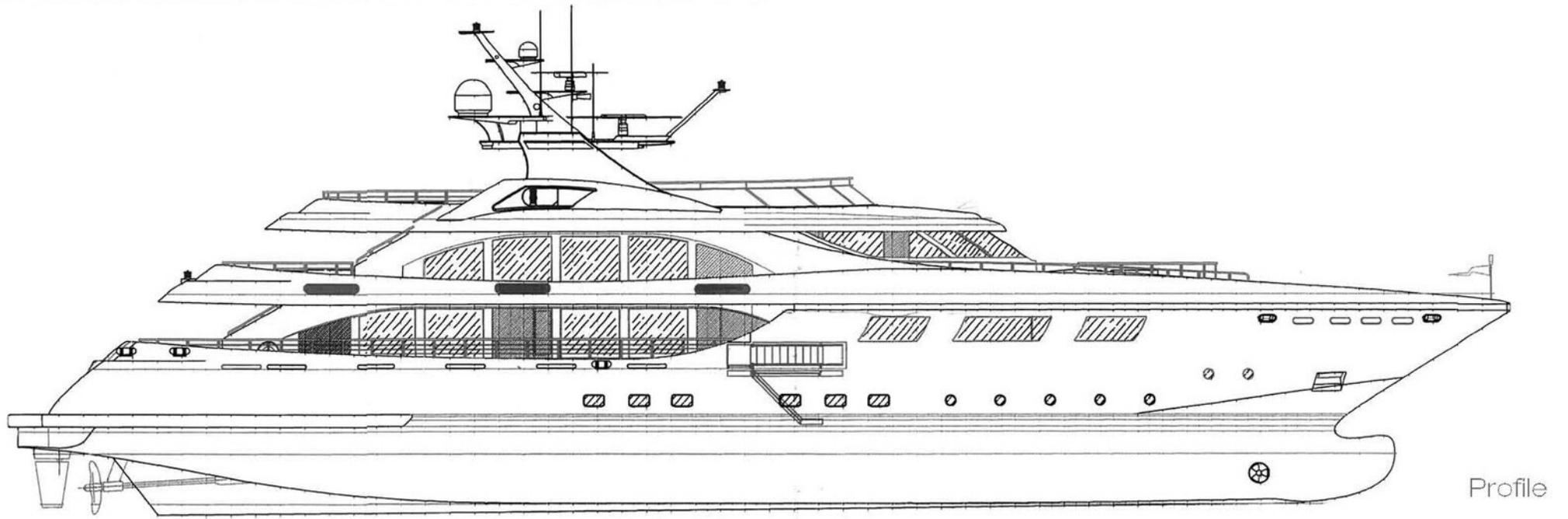

Profile

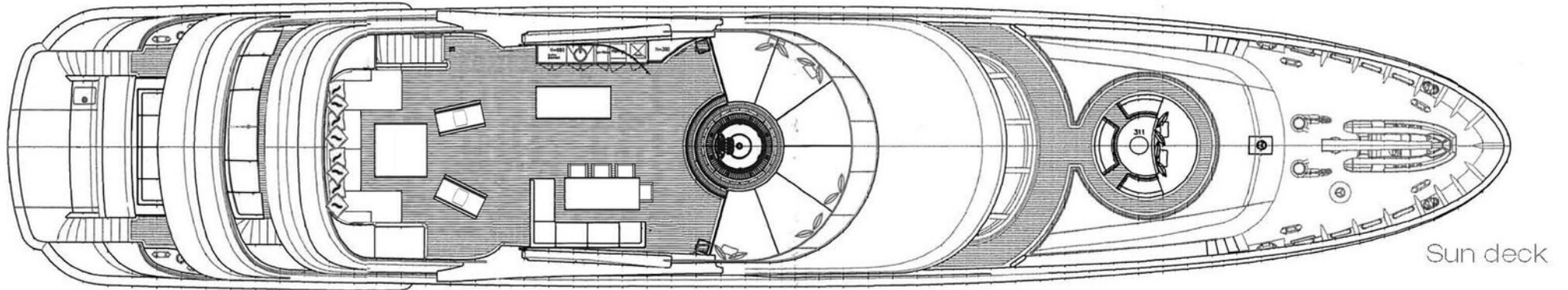

Sun deck

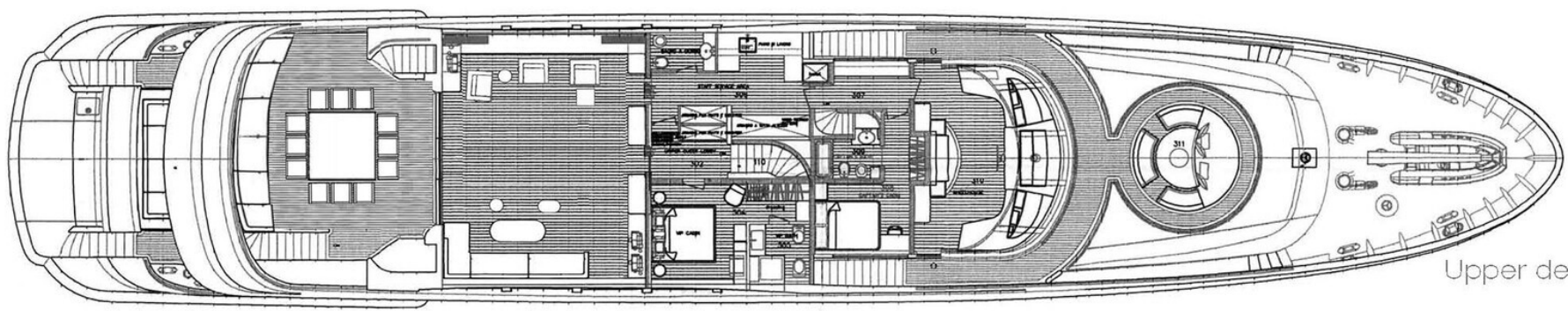

Upper deck

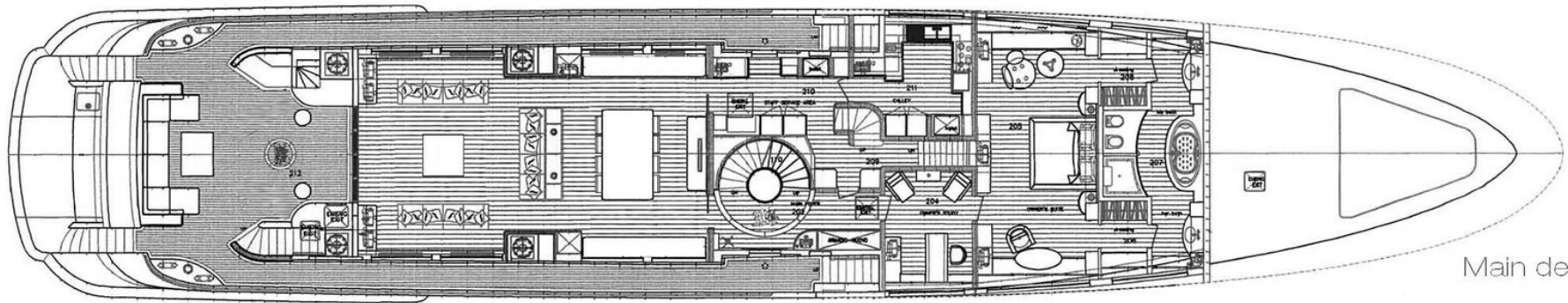

Main deck

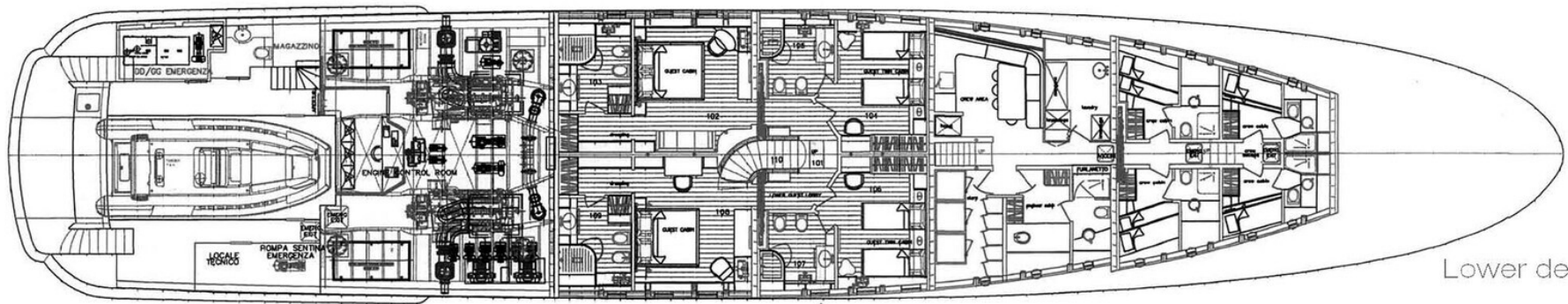

Lower deck



Arbema

CONTENTS

- 1 MAIN CHARACTERISTICS
- 2 DIMENSIONS
- 3 SPEED & RANGE UNDER POWER
- 4 CAPACITIES
- 5 ACCOMMODATION
- 6 MECHANICAL EQUIPMENT
- 7 NAVIGATION EQUIPMENT
- 8 COMMUNICATION EQUIPMENT
- 9 DECK EQUIPMENT
- 10 ENTERTAINMENT EQUIPMENT
- 11 GALLEY & LAUNDRY EQUIPMENT
- 12 SECURITY & SAFETY EQUIPMENT
- 13 TENDER & WATERSPORT EQUIPMENT
- 14 REFIT LIST
- 15 COMMENTS



1. MAIN CHARACTERISTICS

TYPE	Full Displacement Motor Yacht
HULL	84/05D
BUILDER	Ortona Navi
NAVAL ARCHITECT	Ortona Navi
EXTERIOR DESIGN	Progetti & Associati
INTERIOR DESIGN	Vincent Van Duysen
YEAR	2008
REFIT	2022
CLASSIFICATION	DNV-GL (Det Norske Veritas), Commercial/ISM/ISPS/MLC
CONSTRUCTION	Steel Hull & Aluminium Superstructure, Teak Decks
CREW	Up to 12 crew
FLAG	Malta
ENGINES	2 x 1,574 Hp / 1,174 kW Caterpillar 3512B
GT	591

2. DIMENSIONS

LOA	49.90m / 163'8"
LWL	43.64m / 143'1"
BEAM	9.19m / 30'2"
DRAFT	2.71m / 8'89"
CABIN HEIGHT	2.10m / 6'10"
MAX BRIDGE CLEARANCE	18.00m / 59'

3. SPEED & RANGE UNDER POWER

MAXIMUM SPEED	15 knots @ 1,600rpm
----------------------	---------------------

CRUISING SPEED	13 knots @1,250rpm
PASSAGE SPEED	9 knots
FUEL CONSUMPTION	With 2 x engines 1 x genset 272 litres p/ hr @ 14 knots 166 litres p / hr @ 12 knots 125 litres p / hr @ 11 knots 95 litres p / hr @ 10 knots
RANGE	4,300 nm

4. CAPACITIES

ACCOMMODATION	12 x Guests in 6 cabins
CREW	Up to 12 x Crew in 6 cabins
FUEL	79,100 litres / 20,896 US gallons
FRESH WATER	19,755 litres / 5,219 US gallons
LUBE OIL	3,000 litres / 793 US gallons
DIRTY LUBE OIL	1,200 litres / 317 US gallons
GREY WATER	9,180 litres / 2,425 US gallons
BLACK WATER	9,180 litres / 2,425 US gallons

5. ACCOMMODATION

MAIN DECK OWNER'S SUITE

The Master Suite is very spacious, situated on the Main deck with a link to the study. Featuring a very large en-suite shower room clad in Onyx with a double entrance for his and hers, and a large Jacuzzi bath in the middle. The wall is encrusted in Quartz Fossile Nautilus and there is a further separate shower room and separate WC.

VIP CABIN

On the Upper deck, this is a double cabin with panoramic views and an en suite

shower room. The bed is 1.65m x 1.94m.

LOWER DECK GUEST CABINS (4)

2 x twin cabins that can be converted into double cabins (double bed size: 2m x 1.65m) with a small office. Both cabins have en-suite shower rooms.

2 x spacious double cabins with en suite shower rooms, & open dressing areas (bed size: 2m x 1.8m/ 2m x 1.74m).

All cabins have safes (master has two), lots of wardrobe space, LCD TVs and Sky TV with independent decoders for every cabin, DVD, radio and CD player. Each deck has its own independent music system.

CREW ACCOMMODATION

Up to 12 x crew in 6 cabins (total including Captain's cabin)

Captain's cabin on Bridge deck

5 x Twin bunk cabins on forward Lower deck with crew mess, laundry and dry stores

GENERAL

All interiors have wooden flooring in Wenge and the Master is decorated in light oak.

All cabins have safes (2 x in Master), lots of wardrobe space, LCD TVs and Sky TV with independent decoders for every cabin, DVD, radio and CD player. Each deck has its own independent music system.

Large sunbathing area with Jacuzzi for six. Sun deck table sits 12, although 10 comfortably, Bridge deck table seats 12 comfortably.

DESCRIPTION

The interior layout is highly practical for larger groups, and she sleeps up to 12 guests in 6 cabins, including a VIP cabin on the Bridge deck, a very large master suite on Main deck, and 2 double cabins and 2 twin cabins on the Lower deck. Overall this is a tried and tested layout perfect for family or charter use. She is also capable of carrying up to 12 crew to ensure that guests have a genuine superyacht 1:1 guest to crew ratio. Her contemporary interior is very comfortable and luxurious but has also been designed

to be hard wearing and therefore robust enough for the charter season.

On deck, four completely different social areas can be enjoyed, the highlight of which is her generous 140m² Sun deck, with luxuries including a large custom Jacuzzi, huge sun pads and a dining area complete with a bar and large gas-fired BBQ for casual al-fresco dining. The forward cockpit benefits from a circular enclosure of sofas, with two further and distinct al fresco dining areas found on the Upper and Main deck aft.

6. MECHANICAL EQUIPMENT

ENGINES	2 x Caterpillar 3512B Marine Diesel, Stern drive 1,574 Hp / 1,174kW @1,600 rpm each Next major service at 12,000 hours
ENGINES HOURS	Port: 9,026 hours as of 08th Aug 2022 Starboard: 9,038 hours as of 08th Aug 2022
GENERATORS	1 x 150 kW Caterpillar 1,500 rpm 1 x 80 kW Caterpillar emergency generator
GENERATORS HOURS	Port: 21,414 hours as of 08th Aug 2022 Starboard: 22,733 hours as of 08th Aug 2022
EMERGENCY GENERATOR	1 x 80 kW (107 Hp) Caterpillar Diesel
STABILISERS	CMC (Zero speed and under way)
STERNTHRUSTER	Trac 90 kW
BOWTHRUSTER	Trac 90 kW
GEARBOX	ZF 2.7:1 reduction gearboxes
PROPULSION	Aquamet inline shafts driving 5-blade props
STEERING	Twin Steering Bowmands Port/Starboard with 2 x hydraulic pump (independent)
ELECTRICITY	380v/220v/24v electrical plants/50Hz
BATTERIES	24v/100V/aH
SHORE POWER	380v/90 A max 3-phase synchro
INVERTER	90 Kva

AIR CONDITIONING	Condaria Airconditioning Fresh Air-Exchanger Vent
AIR COMPRESSOR	Central Compressed Air system
WATER MAKER	2 x HEM 750LPH 600 litres/hour
BOILERS	2 x 200 litres/hour (new 2022)
SEWAGE SYSTEM	Biocon
TOILET SYSTEM	Jets System
OILY WATER SEPARATOR	Oceanclean
FUEL SEPARATOR	Westfalia

7. NAVIGATION EQUIPMENT

GYRO COMPASS	Sperry Marine MK compensated
MAGNETIC COMPASS	Northrop Grumman
LOG	Furuno. Doppler Speed Log. DS-80
RADAR	Furuno Far 2117 X band
TRANSPONDER	2 x GMDSS SART Transponder McMurdo
DEPTH SOUNDER	Furuno FE-700
SONAR	Furuno CH - 250
AUTOPILOT	Sperry Marine, Navipilot V HSC
GPS	Furuno GP150 (X2)
NAVTEX	Furuno Navtex NX - 700
WEATHER FAX	Furuno Fax 207
AIS	Furuno FA-150
WIND INSTRUMENTS	Airmar 150WX Weather Station
CHART PLOTTER	Transas ECDIS electronic chart system
CAMERAS	CCTV integrated system with cameras

8. COMMUNICATION EQUIPMENT

SATCOM	Satellite Internet Antenna Seatel 4003 VSAT 3612 Seatel System
INMARSAT C	2 x Sailor TT - 3020 C transceivers 2 x Sailor TT - 3606E message terminals
BROADBAND INTERNET	Siswall Integrated System
WIFI	WiFi throughout yacht
GSM	Panasonic KX-T7636
VHF	Sailor VHF RT 5022 DSC Sailor RT 5022 DSC Duplex Sailor VHF C 4901 DSC
TELEPHONE EXCHANGE	GSM PABX c/w antenna, Panasonic TDA30
PRINTER / FAX	HP Laserjet Pro 200

9. DECK EQUIPMENT

ANCHORS	2 x 360 kg
ANCHOR CHAINS	2 x 137,15m of 19mm chain
CRANE	Hydraulic crane on foredeck
WINDLASSES	2 x Lewmar 26 cm diameter electric
PASSARELLE	1 x Bitecnomare
BATHING LADDER	1 x Stainless steel
STERN CAPSTANS	2 x Lewmar 22 cm diameter
UNDERWATER LIGHTING	Furlanetto

10. ENTERTAINMENT EQUIPMENT

UPPER DECK

- 3 x Zones: Saloon, Aft, Sun deck
- Vidabox Media Server (Music Library- iTunes compatible)

- iPod Docking Station + iPod
- Airplay player 4.5 CDs Changer
- Radio Tuner FM
- Controlled By Crestron System using mini iPad

UPPER DECK SALOON

- 65" 3D Led Display 2.3D BD player
- Vidabox Media Server (Movies Library)
- Satellite Receiver Sky UK & Sky Italia
- Controlled By Crestron System using mini iPad

MAIN DECK

- 2 x Zones: Saloon & Aft Deck
- Vidabox Media Server (Music Library- iTunes compatible)
- iPod Docking Station
- Airplay player 4.5 CDs Changer
- Radio Tuner FM 6. Controlled By Crestron System using mini iPad

MAIN SALOON

- 65" 3D Led Display
- 3D BD player
- Vidabox Media Server (Movies Library)
- Satellite Receiver Sky UK & Sky Italia
- Controlled By Crestron System using mini iPad

MASTER SUITE

- 2 x Zones: Bedroom & Bathroom
- Vidabox Media Server (Music Library- iTunes compatible)
- iPod Docking Station
- Airplay player
- Radio Tuner FM

- Controlled by Crestron System using mini iPad

BEDROOM

- 46" 3D Led Display 2.3D BD player
- Vidabox Media Server (Movies Library)
- Satellite Receiver Sky UK & Sky Italia
- Controlled by Crestron System using mini iPad

GUEST CABINS - VIP CABIN

- 48" 3D Led Display
- 3D BD player
- Vidabox Media Server (Movies & Music Library- iTunes compatible)
- Satellite Receiver Sky UK & Sky Italia
- Mini Audio System including: Radio Tuner, Airplay, ipod compatible
- Controlled by Crestron System using mini iPad

NETWORK

- Wi-Fi Network in all areas
- Hi Speed internet thru VSAT, 4G, Hot Spot and Shore Cable

11. GALLEY & LAUNDRY EQUIPMENT

REFRIGERATOR	8 x Refrigerators
FREEZER	4 x Freezers
STOVE	1 x Miele
	2 x MKH combi ovens
MICROWAVE	1 x Miele M 8261
ICEMAKER	2 x Brema
DISHWASHER	3 x Miele G 1232 SCi
WASHING MACHINE	3 x Miele Professional
CLOTHES DRYER	3 x Miele Professional

12. SECURITY & SAFETY EQUIPMENT

EPIRB	Ocean Signal LTD Safe SGA E100G
LIFE RAFTS	4 x RFD 12 pax 2 x Zodiac 12 pax
LIFE JACKETS	56 x Solas approved
FIRE-FIGHTING EQUIPMENT	2 x Firemen outfit 2 x Breathing apparatus 4 x Spare air bottles
FIRE FIGHTING ALARM	Notifier Italia AM – 4000
ULTRA FOG	All interior, engine room and foam system
BILGE & FIRE PUMPS	Centralised manifold type with monitoring alarms
SEARCHLIGHT	4 x Sanshin HR – 1012
SECURITY CAMERAS	CCTV integrated system with cameras
SHIPS SAFES	8 in total

13. TENDER & WATERSPORT EQUIPMENT

TENDERS	1 x Castoldi 23ft 265Hp Yanmar (2014)
JETSKIS	1 x Seadoo Limited 265, Wake Pro 215 (Intelligent Brake & Reverse System) 1 x Seadoo Limited 155 1 x FunAir Jetski dock
WATERSPORTS EQUIPMENT	1 x FunAir Sun deck Slide 4 x Stand Up Paddelboards 1 x Subwing 2 x Inflatable double handed kayaks
TOWABLES	1 x Connelly Orbiter 3 Seater 2 x Connelly Big O Single Seaters 1 x Connelly 2 Seater 1 x Connelly 2 person Fly Tube

DIVING

Complete sets of water gear:

Diving Masks

Fins

Snorkels

Swimming Goggles

Water/ Swimming Shoes

SKIS & BOARDS

1 x Connelly Odyssey (Double Skis)

1 x Kneeboard

1 x Single Ski Radar P-Six

1 x Connelly Super Sport Kids Skis

1 x Adult Wakeboard

1 x Kids Wakeboard

SAFETY GEAR

3 x Headgear for Fly & Hover boards

PFD's (S, M, L, XL, XXL)

Exclusion list available on request

14. REFIT LIST

2021-2022

- Full paint of superstructure
- Repainting of the exterior deck head panels
- Partial replacement of teak decks
- Flexiteak installed around the jacuzzi
- All 4 stabilisers removed and overhauled
- Tail shafts removed and inspected, new bearings
- New Stern seals and carriers and shaft earthing
- Full rebuild of foredeck crane
- Full rebuild of passerelle including new power pack

- Hot water boilers replaced
- Bilge water tank replaced
- Main engine cooling circuits flushed
- New quick closing valves installed on fuel tanks
- Service of tender launching system
- New Cat A fire door installed on emergency generator room
- Castoldi tender serviced
- Jetskis serviced
- Watertight doors inspected by manufacturer

Full year 2020

- Full interior refit by Vincent Van Duysen at Monaco Marine Toulon
- Full hull paint job
- Teak upgrades throughout
- New exterior furniture and tables throughout
- New sun pads
- New toys and inflatables
- Various Bridge upgrades
- Various AV upgrades
- Upgraded the VSAT domes as part of the AV Upgrade with Sona and Axxess marine
- All new crockery and glassware

WINTER 2017-18

- 10 year survey completed at MB92, Barcelona
- New freezer compressor installed
- All through hull valves overhauled or replaced
- Main engine and generator exhaust valves replaced
- Sea water crossover valves overhauled/replaced
- Engine room ventilation fan motors overhauled

- Engine room fan cowlings installed
- Forward exhaust space entry hatch installed
- Shafts removed and alignment checked
- Gearbox height adjust on Port engine
- Shaft pitting repaired
- New shaft seals installed
- Rudder clearances checked
- Starboard main engine exhaust silencer weld repair
- Forward crane full hydraulic maintenance
- Tender garage cradle hydraulic rams replaced
- Forward jet-ski garage Hydraulic rams/hoses replaced
- Starboard side gangway hydraulic maintenance, new hoses, power pack & valve block overhauled, adjustable return valve installed to stop 'bouncing'
- Stern door and swim platform hydraulic rams replaced/overhauled
- Sea Bob charging points installed
- Ultra-fog 10 year maintenance and survey
- Overhaul JETS pumps. New seals and motor bearings
- Hot water boiler #2 lagging replaced
- AC pipework/manifold lagging replaced in ER
- Black/grey water tanks – Hull plating replaced due to corrosion
- Fresh water tanks inspected/cleaned/painted
- Tank cleaning – Bilge, dirty oil, fuel overflow, sludge
- AC sea water pipework replaced with copper nickel
- Fuel tank #6 centre – Repair carried out on corrosion
- Fresh water carbon filter bypass pipework installed
- Bow and Stern thruster oil change, oil analysis good
- OWS annual maintenance and filter change
- Sewage treatment plant tank replaced
- Main bilge pump – Overhauled

- Installed 2 new boiling water taps
- Starboard generator – New HUEI fuel pump installed and 6 new injectors
- New silver ion water treatment unit installed
- New UV water sterilizer unit installed
- 'Resilience' name light LED's changed
- Port forward capstan motor replaced
- Stabilizer cooling water pump replaced
- Hydraulic ram Starboard aft stabilizer – Seals replaced
- Stern repainted by Pinmar in MB92
- Forepeak hatch modified
- Deck scatter cushion inserts all replaced
- New cushion covers for Sun deck forward
- Technical spaces fully repainted – Bulb compartment, Forepeak, forward garage, after tender garage
- All new watersports life jackets (Jobe)
- New snorkel masks sets
- New swimming fins (complete sets)
- 6 x new swimming goggles
- 2 x new rigid kayaks (Hobie Quest 11)
- 6 x new watersports Helmets (Jobe)
- Jetskis serviced by authorised dealer
- Jet 23m hose for Flyboard
- New varnish teak drinks tables for Sun deck forward area
- New rescue boat rain cover
- 4 x new mooring lines

WINTER 2016-17

- Steering and Stern thruster hatches replaced with alloy/seal type
- Ultrafog system annual maintenance
- Crew/Galley dumb waiter removed

- Crew mess – Full refit
- Ultrafog flushing valves installed
- Bridge/ER/Wing station Kobelt controls – Potentiometers replaced
- Port/Starboard generators – Silencers installed
- Port/Starboard generators – Hull cowlings installed
- New steering control board installed. 2 new additional boards ordered
- Shore power comm. module repaired
- Black/grey tank level sensors installed
- Galley exhaust fan and ducting installed
- Galley fan frequency drive installed
- Galley exhaust quick closing damper installed (Heinen and Hopman)
- Full yacht duct cleaning carried out (Heinen and Hopman)
- Tender fuel filling system installed (Marine metal works, Barcelona)
- Tank cleaning – Bilge, dirty oil, fuel overflow, sludge, black and grey water
- Tank cleaning – Fresh water tanks. Paint touch ups
- New hull anti fouling applied
- Hull plate repair – Fuel tank #5
- Refrigeration system pipework replaced with copper pipe. (Marine metal works, Barcelona)
- Main sea water inlet valves overhauled – 2 main SW crossover, AC intake, ultra-fog and refrigeration
- Passerelle hydraulic flow valve installed to stop 'bouncing' motion
- Major service on all 4 CMC Stabilisers – Fins removed, shafts inspected, damaged shafts repaired, damaged rams replaced, hyd oil system flushed, filters changed, seals replaced, bushing replaced, new seal covers installed
- Hot water boilers opened, inspected, cleaned, faulty elements replaced, top cover plates replaced due to corrosion, temp gauges replaced
- Hot water circulation pump replaced
- OWS annual maintenance and filter change

- LED exterior step lighting replaced
- Refrigeration SW pumps replaced
- New stainless Stern fenders
- New stainless Swim ladder
- New Sun deck awning
- New Sun deck umbrellas (Tucci)
- New custom made fender hooks Set
- New passerelle stations
- New varnish inserts on Main deck and Bridge deck aft
- Varnish tables sent off for coats of varnish
- 2 x new seabobs (F5)
- Jetskis serviced by authorised dealer
- Rescue boat engine sent off for service and prop seals replaced
- New rescue boat anchor points fitting to foredeck
- Swim platform teak recaulked
- New Henrikson hook for rescue boat crane
- New lifting harness for rescue boat
- Glass table top on Bridge Deck Aft remade
- New cushion covers for Sun deck forward
- Pyrotechnics replaced
- Locker door latches replaced

WINTER 2015-16

- Generator 10000 Hr. services carried out (Port and Starboard)
- Bow thruster and Stern thruster given full rebuilds. Electronic control card replaced
- Installed new fresh water pumps, frequency drives and pipe work
- Installed new HEM water maker
- Installed Cathelco Anode system
- Hull plating around generator exhausts (Port and Starboard) replaced due to corrosion

- Tender cradle hydraulic rams rebuilt
- Tender garage doors hydraulic rams rebuilt, new hoses
- Steering gear hydraulic rams rebuilt, all new hoses installed (HMC, France)
- Forward crane hydraulic hoses replaced (HMC, France)
- AC compressors #1 and #3 replaced, new filters and Exp. valves (Penguin Marine, France)
- Sun deck void space exhaust fan replaced
- New fresh water softener installed
- New hot water circulation pumps installed
- Sewage treatment plant – 5 pumps replaced, new level switches

FULL YEAR 2014

- Full paint job out of water
- Full interior redesign
- Sun deck completely re-styled
- Every technical area of the yacht was refurbished
- All equipment was fully serviced
- Totally new interior and exterior furniture
- New toys
- New soft furnishings throughout - linens/curtains etc.

15. COMMENTS

A high volume yacht of nearly 600 GT, ARBEMA was built in 2008 in Italy by Ortona Navi International with steel hull and aluminium superstructure, and benefits from a very stable full displacement hull with a beam of more than 9 metres. Her natural stability is further enhanced with a very effective zero speed stabilisation system, reducing the roll motion effect and resulting in increased passenger comfort under way. Cruising speed is a comfortable and relatively rapid 13 knots and she has a maximum speed of 15 knots. She also has a better than transatlantic range of over

4,500nm at economic speeds.

In late 2019 she was bought under the name ARBEMA. Over the last 2.5 years of this ownership, she has benefited from huge investment and brought up to a level that not many yachts her age could equal. This condition has been obtained via an extensive refit program which took place in early 2020 and a huge refit over the 2021/22 winter period. While she cruised once to the Caribbean, she has been based in the Mediterranean for the summer seasons. It is fair to say without any exaggeration at all, that she is a much better yacht today than she was in 2019.

On the charter side she possesses an excellent charter record over the last 7 years, and she consistently books at least 10+ weeks charter with many repeat bookings – she is a very well-known and well-regarded yacht on the charter market.

KEY FEATURES

- Turnkey condition following multimillion-euro refit
- 6 Cabins with the master on Main deck
- Large Sun deck
- Modern contemporary interior from 2020
- Hull paint completed 2020
- Superstructure paint completed 2022
- Great charter record
- All out of water elements for 5 year survey completed

DISCLAIMER

This document is not contractual. All specifications are given in good faith and offered for informational purposes only. The publisher and company do not warrant or assume any legal liability or responsibility for the accuracy, completeness, or usefulness of any information and/or images displayed. Yacht inventory, specifications and charter prices are subject to change without prior notice. None of the text and/or images used in this brochure maybe reproduced without written consent from the publisher