

# ONBOARD

ROCK.IT







THIS IS NOT A YACHT BROCHURE. IT IS THE STORY OF A FEADSHIP, A UNIQUE ONE-OF-A-KIND CREATION FOR AN OWNER SEEKING THE VERY BEST. IN THESE PAGES WE EXPLORE THE TRUE MEANING OF CUSTOM SUPERYACHT BUILDING AND SHOW YOU HOW THIS PANS OUT IN PRACTICE. FEADSHIP STYLE...

*There are yachts and there are Feadships.*





ROCK.IT



41°21'46" N | 70°57'02" W  
VINEYARD SOUND, RHODE ISLAND, USA







Pure custom creation	10
Perfect craftsmanship	14
Innovations	18
Exterior	22
Sun deck	28
Bridge deck	36
Main deck	46
Lower deck	58
Operational excellence	66
General arrangement plan	74
Contact	76



## THERE ARE YACHTS AND THERE ARE FEADSHIPS

Feadship is one of an elite group of yachtbuilders that can truly be said to create custom superyachts. Custom means starting every project literally with a blank page. It entails designing a bespoke superyacht that is entirely individual and unlike any other in the world. 'Custom' should never be confused with 'customising' – which actually involves tweaking an existing platform or concept. That is not our style at Feadship: we work with clients to create a one-off luxury motoryacht that exclusively and uniquely reflects their character and use. A Feadship in other words...

One of the key desires for the owner of *ROCK.IT* was that his Feadship should be a true hybrid style-wise, blending an innovative and sporty exterior with an old-school, classic-comfort interior. Light pours in through the huge windows showcases *ROCK.IT*'s extraordinarily warm, friendly and homely environment, all wrapped within a completely stylised, modern outdoor jacket. Realising these diametrically opposed interior and exterior requirements is the very essence of pure custom creation and *ROCK.IT* underlines how crucial it is to work with a yard that has rich experience in both fields.

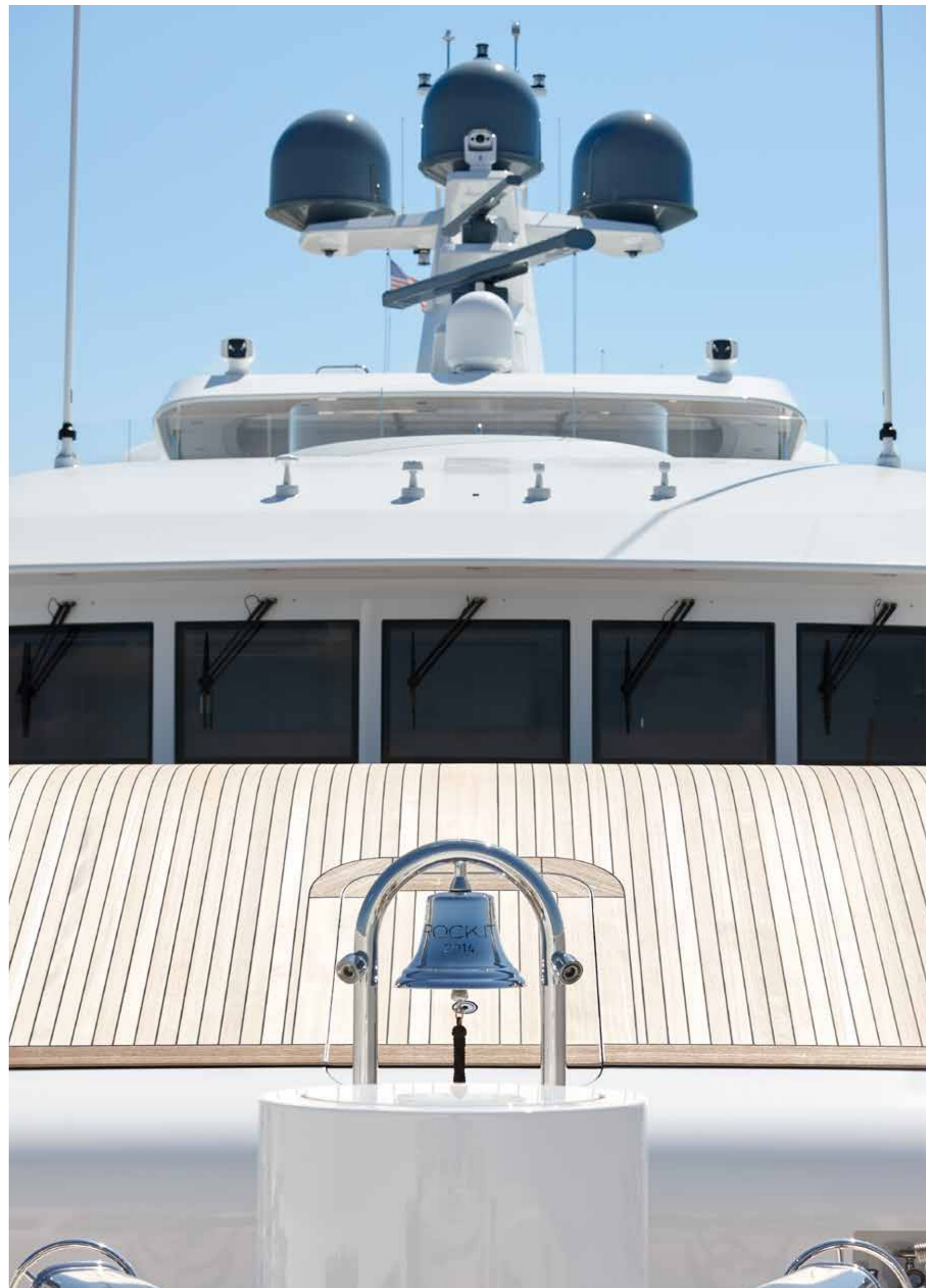







## HOW FAR ARE YOU WILLING TO GO FOR PERFECTION?

However distinctive they may be, every Feadship ever launched has something in common: an inherent quality that you can only really feel when you step aboard and which ensures the vessel holds her value. This is the end product of a perfect craftsmanship that has been passed down the generations. Traditional values are upheld in every discipline as the yards draw on an unrivalled heritage dating back to the nineteenth century. As time goes by, each Feadship sets a new benchmark for artistry and the use of technology to maximise comfort.

The entire interior of *ROCK.IT* is a testimony to the artistry involved in creating a bespoke Feadship. Dark precious woods and light stones are blended in a fantastically detailed classic modern style. Splendidly spacious thanks to the full-beam throughout, crotched mahogany and striking diagonally veneered sycamore panelling generate a very personal touch. Backlit pure White Onyx in combination with an enormous amount of Statuario and sensational slabs of Portoro elevate the interior to a higher level while retaining its primary purpose of being a true family yacht.

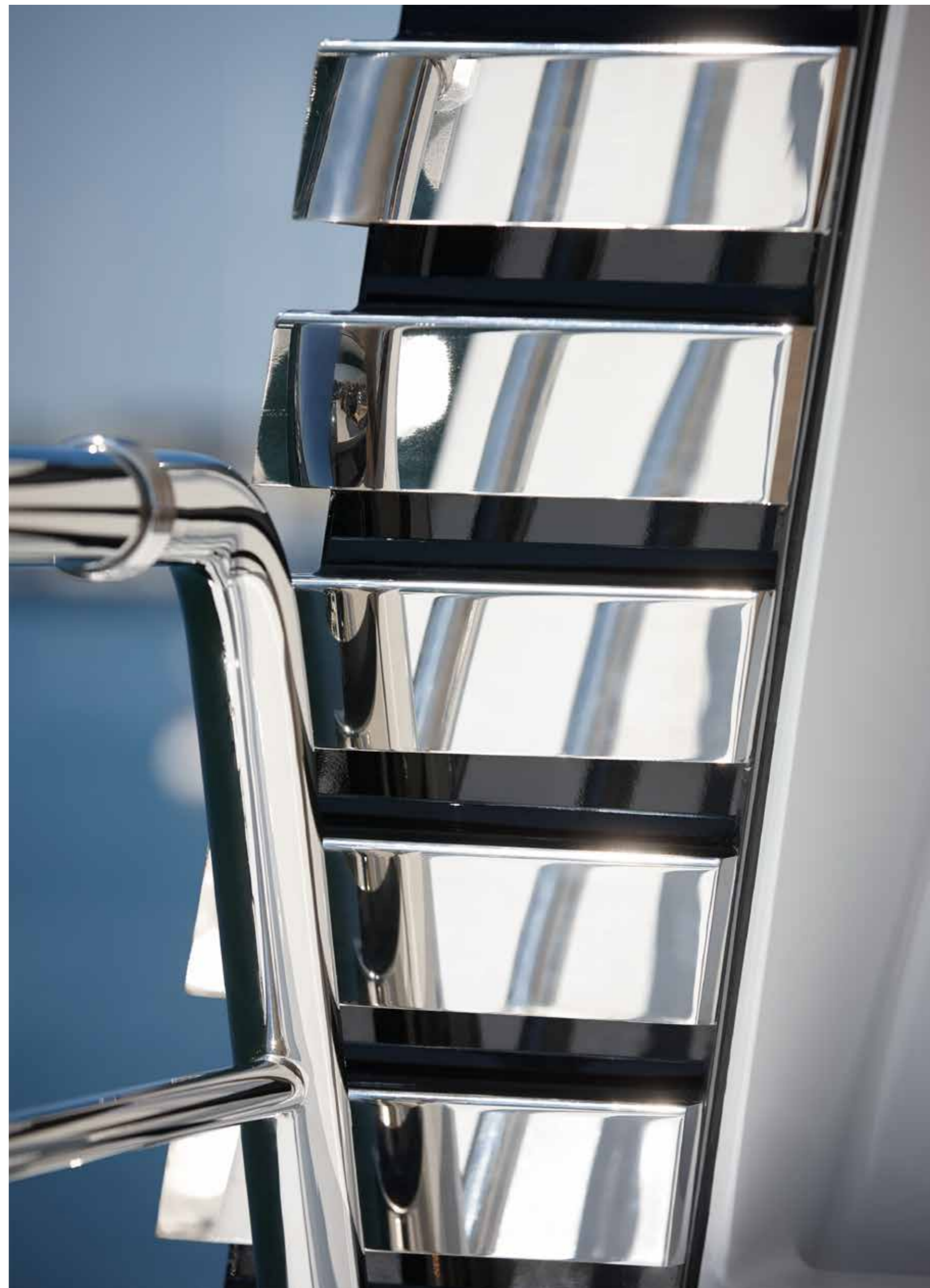







## MAKING THE IMPOSSIBLE

Every Feadship also showcases the relentless pursuit of perfection that has always been the hallmark of the men and women who work at Feadship. Many decades of craftsmanship are combined with a future-oriented passion for excellence. And it's not just the designers at Feadship who are busy with innovation – so too are the shipyards, the project managers and the engineers. While setting new standards in partnership with the clients they serve, all are dedicated to safeguarding the quality, safety and extraordinary comfort for which Feadship is so renowned.

The commissioning owner of *ROCK.IT* fell in love with the Feadship brand and everything it stands for after chartering a Feadship.

Translating his very precise wishes onboard his first ever superyacht build inevitably entailed innovation on multiple levels. For instance, a desire to leverage on recent advances with glass on *Venus* and *Como* inspired the four forward windows, which are curved both horizontally and vertically. See also the unique continuous line running from the arch shape at the stern right through to the bow. These hugely complex design features required immense effort and experience to realise. The galley is also an unprecedented size for a 60-metre yacht, reflecting the owners' personal enjoyment of cooking. No expense was spared to ensure the best possible layout and equipment in this uniquely functional space.









## A FUTURE CLASSIC TODAY

The style of *ROCK.IT*'s elegantly sculpted exterior is destined to be a future classic. A natural flow of lines and surfaces enables the yacht to exude speed in a profile that is super sleek and bold without being pretentious. The four double curved windows are a distinctive design feature, deliberately positioned relatively far forward to emphasise the beauty of the bow.

A continuous line races aft from the bow to add to the swift sensation, while a thick bulwark on the foredeck emphasises both this line and the bevelled edge. Note also the stainless steel grids on all three decks: on the bridge deck these are also home to the exhaust casing, one of many ways in which form meets function on this Feadship.









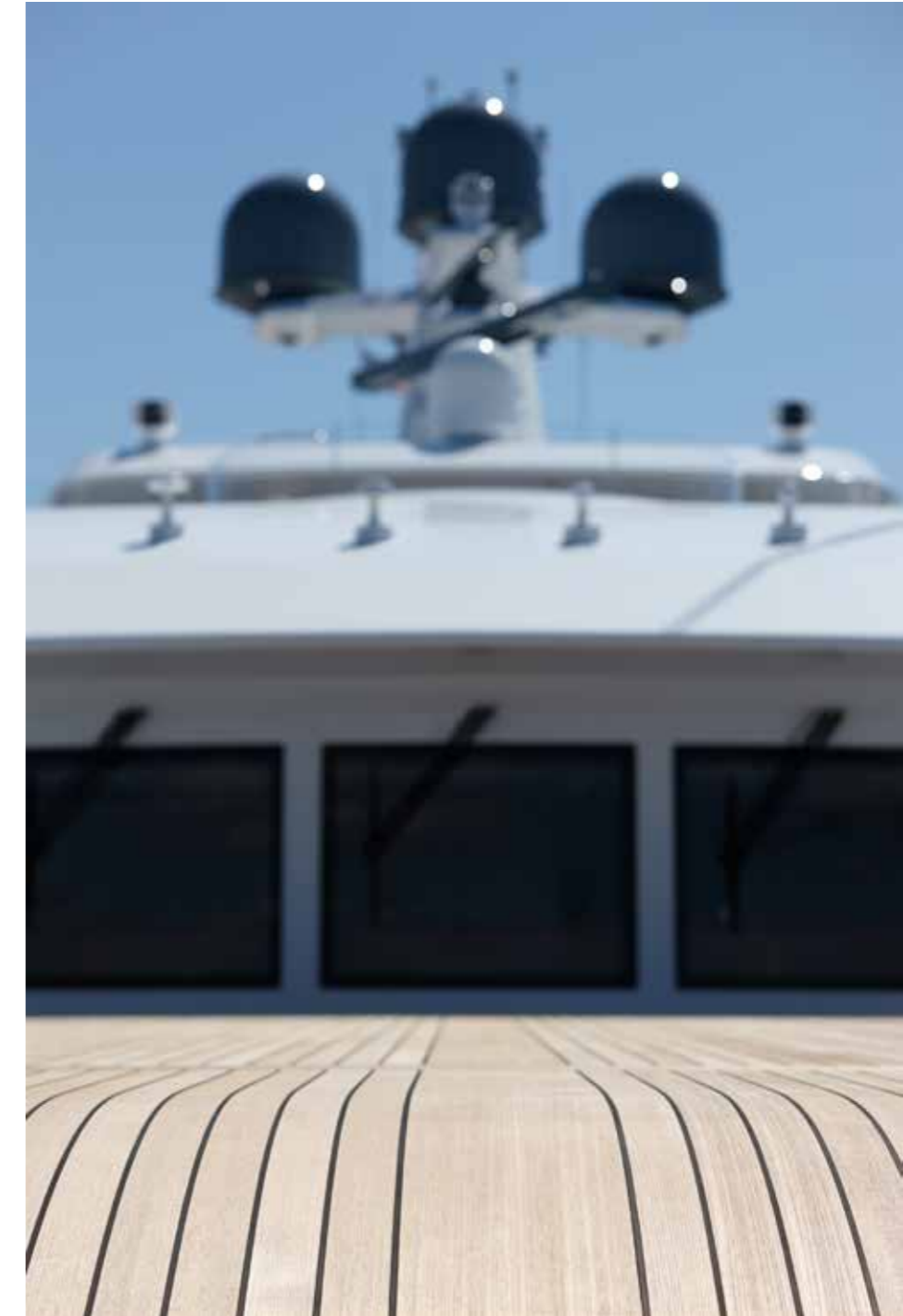



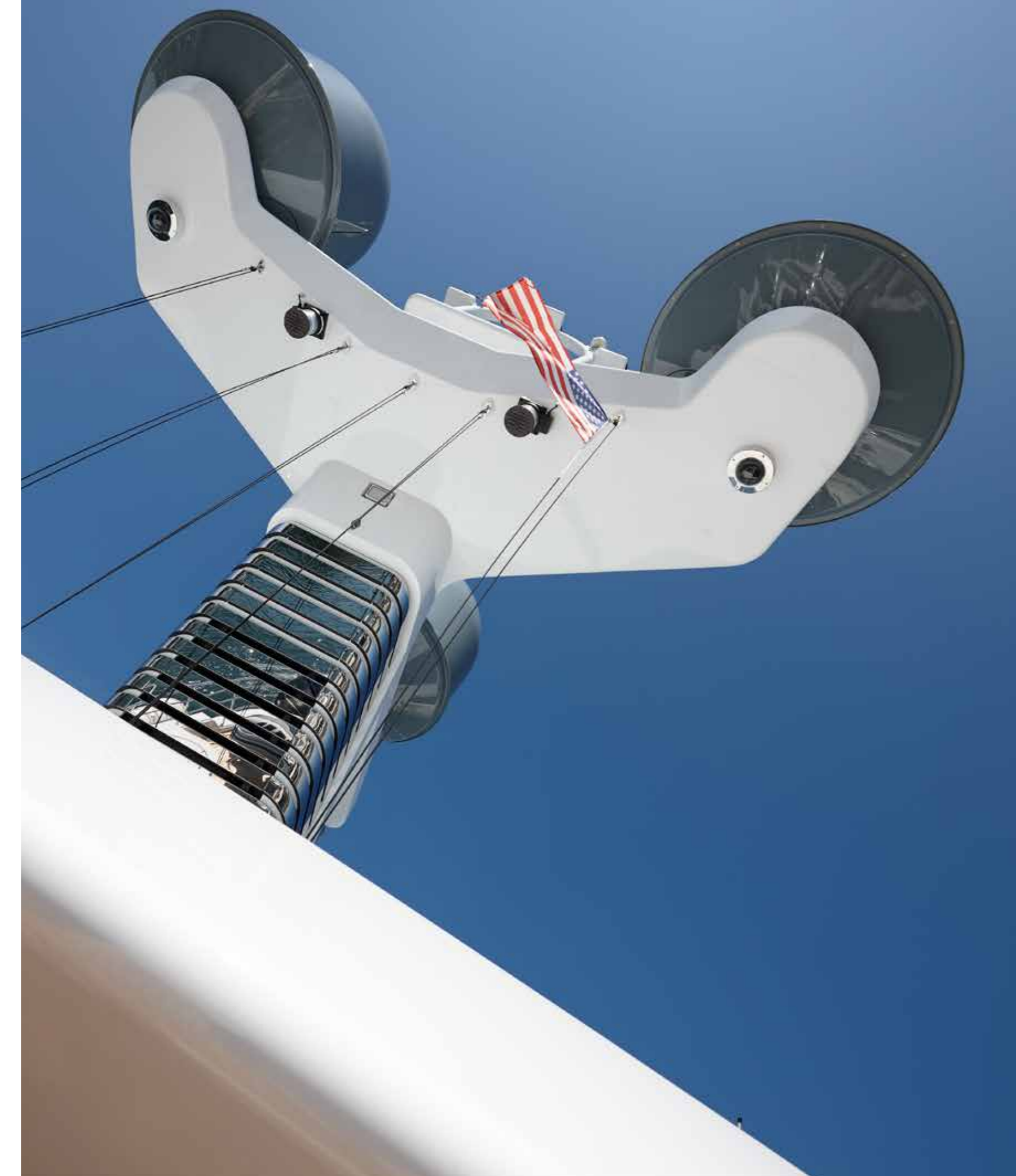
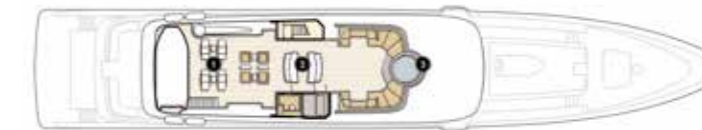

## SUN DECK

One of many striking features on the sun deck is the skylight in the canopy, containing adjustable tinted glass which dims automatically depending on the strength of the sunlight. This sophisticated set-up has an impressive visual effect and facilitates an open ambience while still providing shade. The deck's expansive look & feel is further enhanced by the absence of bulwarks, which removes the boundaries between different sections. There are two bars on the sun deck with a working area in-between in order to serve guests lounging towards the aft area and those or relaxing in or around the Jacuzzi forward.



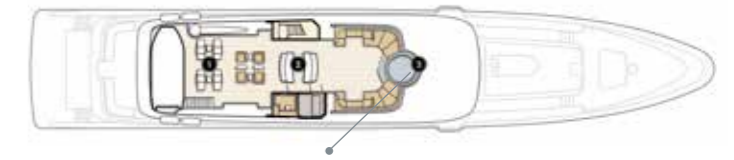



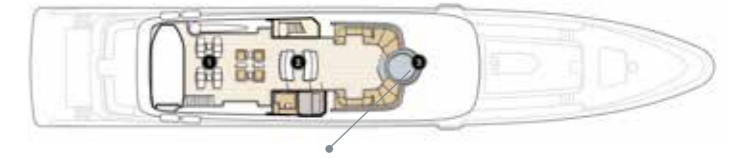









## BRIDGE DECK

*ROCK.IT's* bridge deck exemplifies how this boat blends bold statements with countless intricate details. Take a moment to reflect on the elaborate outside railings shown here, a remarkable example of what can be achieved by experts in stainless steel and wood. Then look at the big picture layout of the combined bridge deck aft and lounge, with its continuous teak deck. The glass windscreens to port and starboard slide back into the superstructure to make more of an open area or slide forward if more enclosed spaces are preferred. Do also note the lovely light sycamore panelling and gorgeous back-lit bar in what is a major social hub onboard *ROCK.IT*.

















5



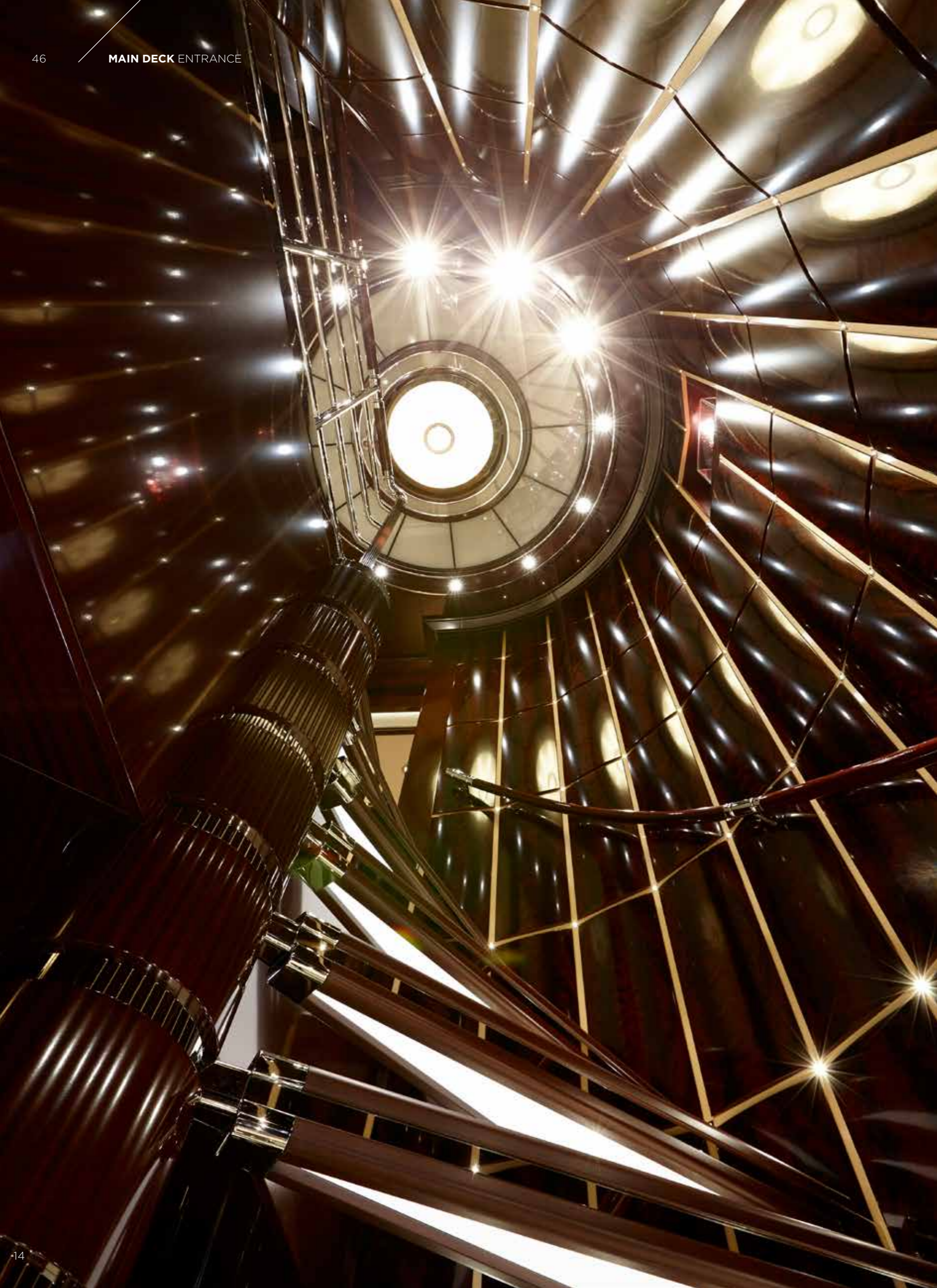

## MAIN DECK

There are no less than 168 individual panels of crotched mahogany in the monumental main staircase with sycamore inlays in-between. Countless LED lights transform this edifice into an exceptionally bright area. The same goes for the main lounge, which has three distinctive sections: a circular wine bar area aft, a giant seating circle amidships with a TV popping out of a cabinet that separates the dining area, with its quite extraordinary table. The owner's stateroom forward is a place of deep relaxation. The 'his & her' bathrooms feature a wealth of backlit stone, and 'hers' has that rarest of things on a superyacht, a freestanding bath! There are 190 pieces of Statuario marble deployed in this space alone.



















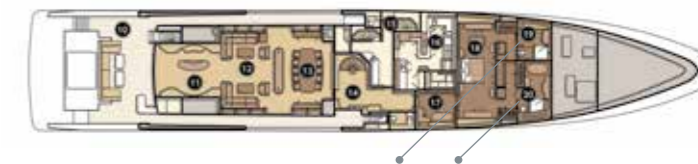





## LOWER DECK

Walking down the leather stairs while admiring the platinum metalwork in the staircase, we arrive at the splendid guest lobby. Take an aft turn and you will reach the two larger VIP staterooms, although the two forward suites are equally as magnificent in terms of their décor. The exceptional use of dark mirrored panels combined with light fabrics continues to generate an inviting setting. There are significantly larger windows here than you would normally expect on a lower deck, which can flood the guest rooms with light or be closed off with floor-to-ceiling blinds. The bathrooms are also of an exceptional size.









27



26









## OPERATIONAL EXCELLENCE

Regardless of how luxurious and elegant superyacht interior may be – and *ROCK.IT* is all that and more – the operational aspects are equally important to an owner's enjoyment. Like every Feadship, the bridge on *ROCK.IT* is endowed with the very latest thinking in comfortable cruising. The crew cabins are among the first to benefit from the new MLC regulations, the captain's cabin is of a very high quality, and

the spacious mess and first-class working facilities also indicate that the owner recognises the importance of a contented crew. In terms of technology, *ROCK.IT* is Feadship state-of-the-art in a conventional package. She was the quietest Feadship ever built at the time of her launch and almost certainly the quietest superyacht not to feature sails.











**GENERAL**

Year	2014
Length overall	60.35 m / 198'0"
Beam overall	10.80 m / 35'5"
Draught (loaded)	3.30 m / 10'10"

Fuel capacity	120,000 litres / 31,700 US Gallons
Fresh water capacity	24,000 litres / 6,340 US Gallons

**DESIGN**

Naval architect	Feadship De Voogt Naval Architects
Exterior styling	Sinot Exclusive Yacht Design
Interior design	Sinot Exclusive Yacht Design

**PROPULSION**

Main engines	2x MTU 12V4000M53R, 1140 kW @ 1600 rpm
Generators	3x Kilopak 175kW
Cruising speed	12 knots
Max. speed	15 knots
Range	5300 NM @ 12 knots

**ACCOMMODATIONS**

Owner	Two in owners' stateroom
Guests	Eight guests in four guest staterooms
Crew	Twelve crew in six crew cabins; one in captain's cabin. Storage rooms, laundry, galley and crew mess on lower deck
Water sports	1x 7.00-metre tender, 1x crew tender, wave runners, etc.



## SUN DECK

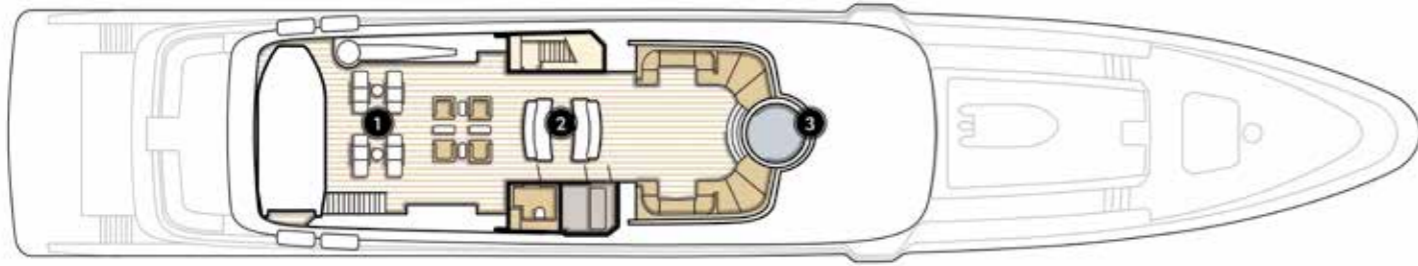

## SUN DECK

1. Sun deck aft
2. Sun deck bar
3. Jacuzzi

## BRIDGE DECK

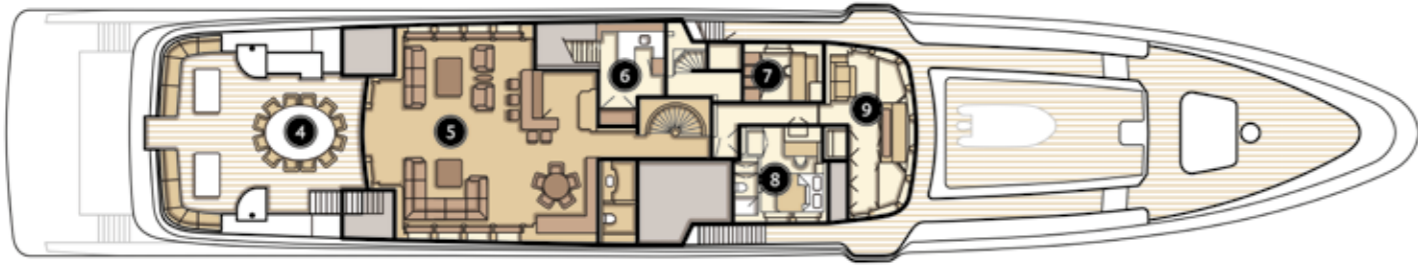

## BRIDGE DECK

4. Bridge deck aft
5. Bridge deck lounge
6. Pantry
7. Ship's office
8. Captain's cabin
9. Wheelhouse

## MAIN DECK

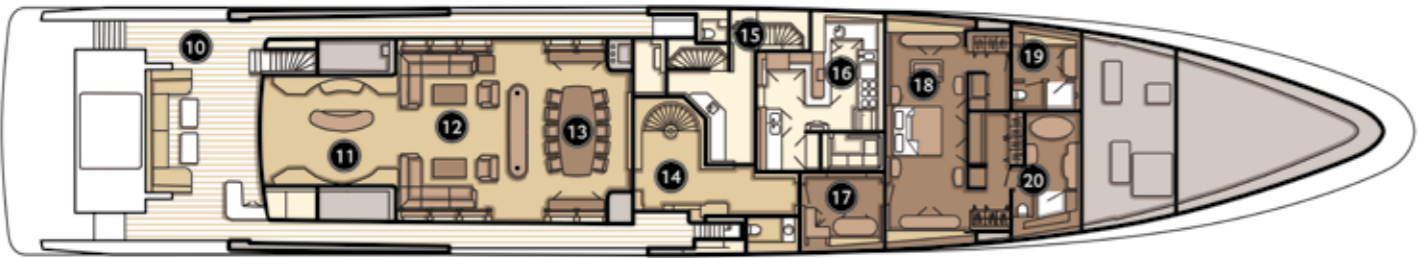

## MAIN DECK

10. Main deck aft
11. Main deck bar
12. Main deck lounge
13. Dining
14. Main entrance
15. Pantry
16. Galley
17. Owner's study
18. Owners' stateroom
19. His bathroom
20. Her bathroom

## LOWER DECK



## LOWER DECK

21. Beach platform
22. Engineer's cabin
23. Engine room
24. Guest stateroom
25. Guest bathroom
26. Guest stateroom
27. Guest bathroom
28. Guest stateroom
29. Guest bathroom
30. Guest stateroom
31. Guest bathroom
32. Laundry
33. Crew lounge
34. Crew cabins

## TANK DECK



## TANK DECK

35. Storage

● GENERAL ● OWNER ● GUEST ○ CREW ● TECHNICAL

SCALE 1:250

Exploring this brochure: the numbers on the general arrangement plans correspond with those given in the photographs.



**FEADSHIP**

Leidsevaart 574  
2014 HT Haarlem  
The Netherlands

T +31 23 524 7000  
info@feadship.nl

**FEADSHIP AMERICA**

801 Seabreeze Blvd.  
Bahia Mar Yachting Center, Suite E  
Fort Lauderdale, FL 33316  
USA

T +1 954 761 1830  
info@feadshipamerica.com

[www.feadship.nl](http://www.feadship.nl)

Follow us:









